

**Double Joint**

for more safety in case of collision

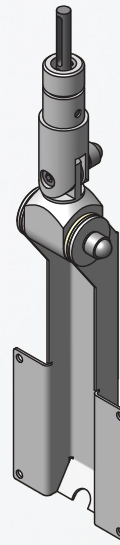

Collision safety – Swing function

**Article-No.:** GD4020

Monitor support for a single 15" - 17" display with VESA 100 adapter suitable for Portegra2 systems

Made in Germany

**GD4020 – Single Monitor Support\* for Portegra2 Systems**

The GD4020 monitor support has been designed for most 15" to 17" monitors. Its double jointed hinge allows a wide range of viewing angles and movement in case of collision.

Combined with the mobility and safety of the Portegra2 suspension arm, the GD4020 offers the user a worry-free and flexible application.

- **Application** Support for one monitor from 15" up to 17"
- **Load capacity** Max. 10.0 kg / 22.0 lbs, incl. cabling (depending on version)
- **VESA adapter** VESA 100
- **Weight** 1.7 kg / 3.7 lbs
- **Cable management** External
- **Colouring** RAL9002
- **Monitor support for** Portegra2 systems  
Stationary mounting (via PT2)  
Ceiling track, optional (via PT2)  
System range: extension arm 750 mm / 950 mm  
spring arm 910 mm

\* Monitor support without extension / spring arm, cabling and monitor.

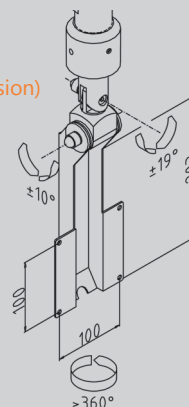
**MAVIG GmbH**X-Ray Protection and  
Medical Suspension SystemsStahlgruberring 5  
81829 Munich  
GermanyPO Box 82 03 62  
81803 Munich  
GermanyPhone +49 (0) 89 / 420 96 - 0  
Fax +49 (0) 89 / 420 96 - 200  
e-Mail info@mavig.com