

**Curved Support**

for two monitors, with handle

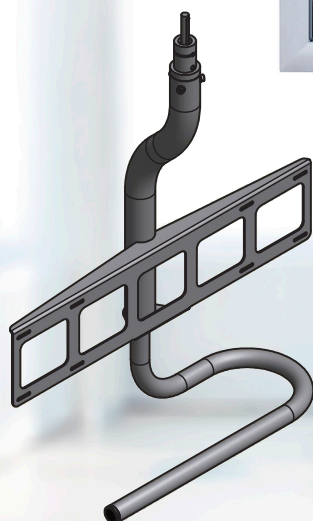

GD4220 Rear view

<b>Article-No.:</b>	<b>GD4220</b>	Monitor support for two displays up to 19", with VESA 100 adapter
	<b>GD4220-L</b>	Monitor support for two displays up to 21"/24", with VESA 100 adapter
	<b>GD4220-XL</b>	Monitor support for two displays up to 24"/26", with VESA 100 adapter

Made in Germany



## GD4220 – Dual Monitor Support\* for Portegra2 Systems

The GD4220 can easily hold up to two 26" monitors (depending on version). The large curved handlebar protects the monitor and provides a means for quick & easy positioning. Combined with the mobility and safety of the Portegra2 suspension arm, the GD4220 offers the user a worry-free and flexible application.

- **Application** Monitor support with handle, VESA 100 adapter for two displays, external cabling
- **Load / Weight**

GD4220	max. 15.0 kg (33 lbs) / 3.0 kg
GD4220-L	max. 14.5 kg (32 lbs) / 3.5 kg
GD4220-XL	max. 14.2 kg (31 lbs) / 3.8 kg
- **VESA adapter** VESA 100 compatible
- **Colouring** RAL9002
- **Mounting** Portegra2 systems for Stationary / ceiling track mounting  
Extension arm 750 mm / 950 mm  
Spring arm 910 mm
- **System range**

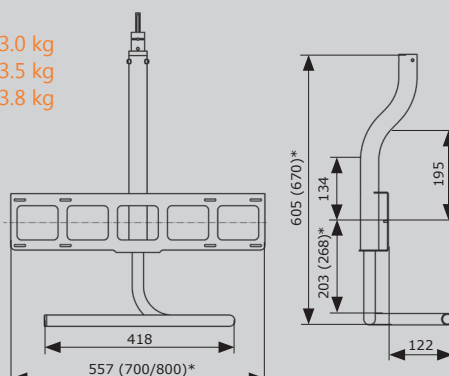

\* Monitor support without extension / spring arm, cabling and monitor(s).

\* (Dimensions for L and XL versions)

**MAVIG GmbH**  
X-Ray Protection and  
Medical Suspension Systems

Stahlgruberring 5  
81829 Munich  
Germany

PO Box 82 03 62  
81803 Munich  
Germany

Phone +49 (0) 89 / 420 96 - 0  
Fax +49 (0) 89 / 420 96 - 200  
e-Mail info@mavig.com